

H3 | H3 direct

 2-5 tons [4,4k-11k lbs]

 max. 3 cm [1 inch]

Hydraulic Flail Mulchers for excavators from 2 to 5 tons

The lightweight H3 for mini excavators is ideal for maintaining hard-to-reach areas and works particularly productively despite requiring little hydraulic power - it mulches grass and brush up to 3 cm [1 inch] in diameter with ease.

The housing is made of wear-resistant steel, the adjustable support roller is reinforced, and the floating attachment is a standard configuration.

The **H3** mulcher is driven by V-belts, as is common with excavator attachments. With the **H3 direct**, the direct coupling of the motor to the rotor eliminates the risk of failure due to wear-related belt breakage under intensive continuous load, and work can be carried out without interruption.

Standard version and specifications

- > Mulches grass and brush up to 3 cm [1"] Ø
- > Excavator category 2-5 tons [4,400-11,000 lbs]
- > Chassis made of high tensile and wear-resistant steel AR400
- > Universal attachment interface
- > Float adapter
- > Transmission
H3: belt transmission with gear motor 11 cm³
H3 direct: direct rotor coupling, gear motor 11 cm³ PLUG & PLAY with DRAINLESS system
- > Front protection with chains
- > Rear protection with rubber flap
- > Adjustable support roller
- > Triple helical rotor with SMW flails

Optional configuration and accessories

- > Individual interface plate for an excavator arm
- > 190° rotation plate
- > Tools selection H3:
 - Y knives
 - Y knives on shackle
- > Motor selection H3:
 - Variable displacement motor VARIO FLOW 22-45 cm³
 - Gear motor 17 cm³



H3



H3



H3 direct

 YouTube www.youtube.com/seppimulcher

Specifications		H3	H3 direct	H3	H3 direct	H3	H3
Working width	cm ["]	60 [25]	60 [25]	85 [33]	85 [33]	105 [41]	125 [49]
Overall width	cm ["]	72 [28]	77 [30]	97 [38]	102	117 [46]	137 [54]
Depth	cm ["]	80 [31]	80 [31]	80 [31]	80 [31]	80 [31]	80 [31]
Height	cm ["]	66 [26]	53 [21]	66 [26]	53 [21]	66 [26]	66 [26]
Weight · base value	kg [lbs]	150 [330]	135 [300]	181 [400]	165 [360]	217 [478]	245 [540]
Belts	qty	3	-	3	-	3	3
SMW flails · standard	qty	6	6	9	9	9	12
Y knives/shackles · OPT-031	qty	12	-	15	-	21	24
Y knives · OPT-458	qty	9	-	12	-	18	24

Tools



SMW



OPT-031



OPT-458
Y-DUO

High-performance hydraulic drive



The **H3 direct** for excavators with a flow rate of 25-60 l/min is driven by a gear motor and is equipped with the **DRAINLESS** system as standard, which is ideal for small excavators without a leakage oil line or for companies with several mini-excavators in their fleet.

The drive system of the **H3** is designed for excavators with a flow rate of 20-130 l/min. For this mulching head, SEPPI M. offers various hydraulic motors with variable displacement as well as gear motors with flow control valve.

HYDRAULIC DRIVE	H3 direct
Pressure	100-250 bar [1,450-3,625 psi]
Return line pressure	max. 5 bar [72 psi]
Required hydraulic flow	25-60 l/min [6-16 gpm]
Required hydraulic lines: 2 (pressure, return)	

HYDRAULIC DRIVE	H3
Pressure	100-300 bar [1,450-4,350 psi]
Case drain pressure	max. 2 bar [22 psi]
Required hydraulic flow	20-130 l/min [5-34 gpm]
Required hydraulic lines: 3 (pressure, return, drain)	

AR400
Robust chassis
made of wear-resistant steel



H3 direct 085

Hydraulic rotation
plate 190°
(option)

With the standard
float adapter
the attached mulcher
follows the contours of the ground



H3 105

Model H3 direct
with direct coupling
of the motor to the rotor

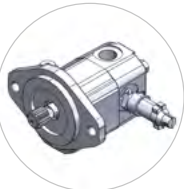

Model H3 with belt transmission
Several motors of choice

Rubber protection
and chains prevent
material ejection

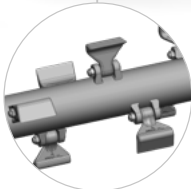

Standard rotor
with SMW flails

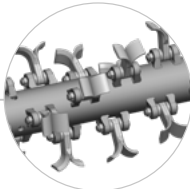

Optional rotor
with Y knives